

# PROPOSED LAYOUT PLAN OF " KUNJ VIHAR VIHAR "

UNDER KHASRA NO.- BORAJ- 1582,1583,1584,1585,1586,1587,1588,1589,1590,1591  
 DEOLA- 871,1500/872,876,877  
 AT REVENUE- VILLAGE- BORAJ & DEOLA, TEH.- MAUZMABAD, JAIPUR

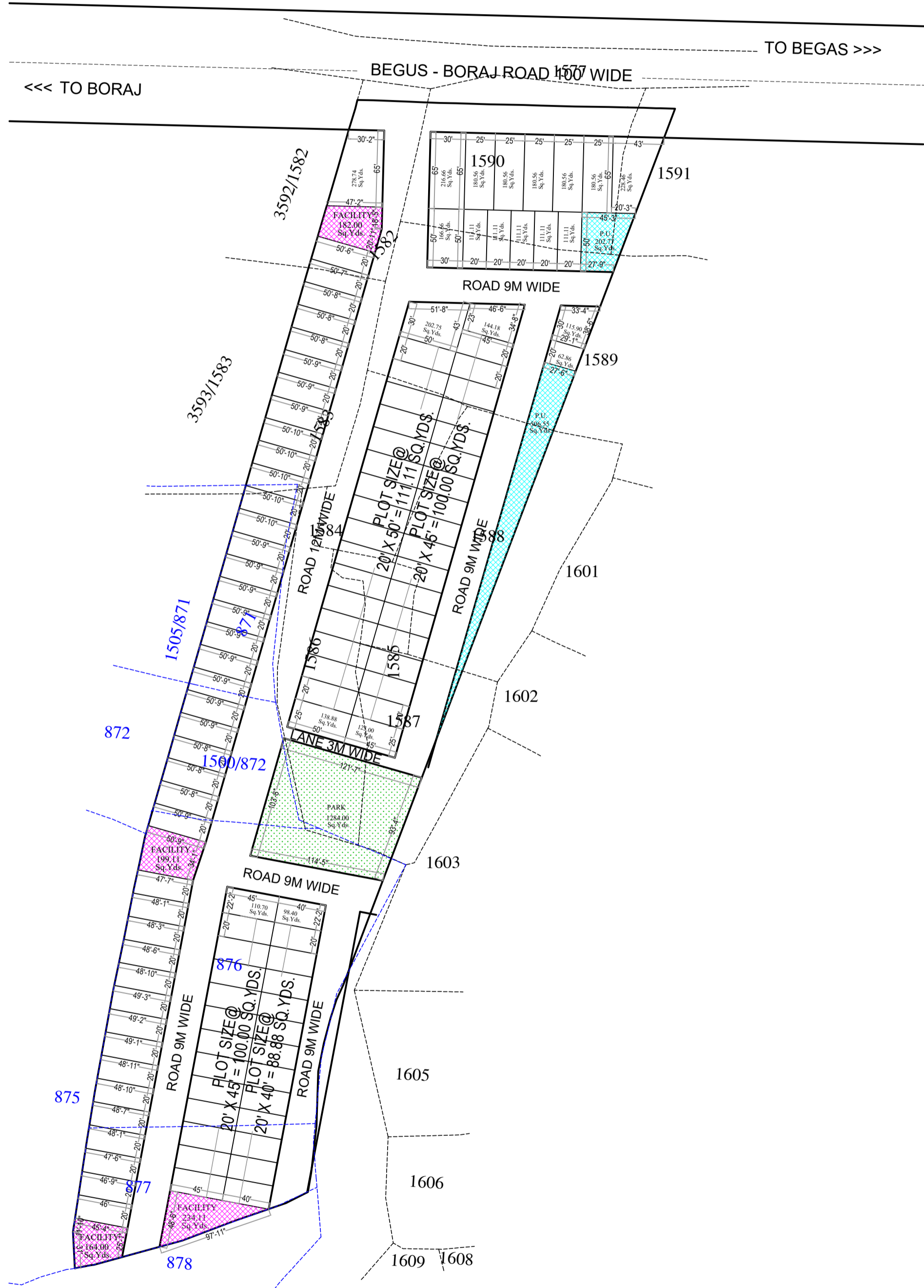

## KHASRA MAP

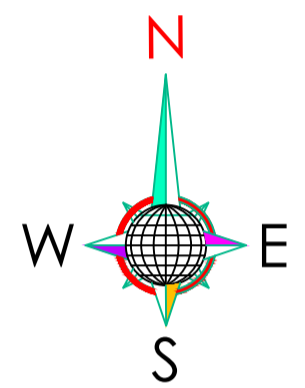
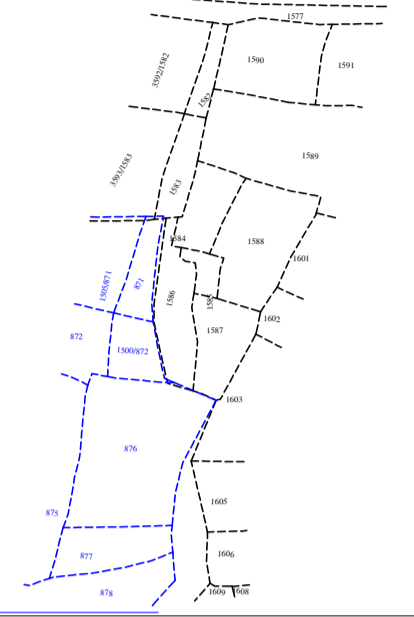

मौके के अनुसार योजना का भू उपयोग व तकनीकी विश्लेषण :-

क्रमांक	भू उपयोग	क्षेत्रफल (Sq.Yds.)	प्रतिशत
1	RESIDENTIAL	13628.66	56.32 %
2	PARK	1284.00	05.30 %
3	PUBLIC UTILITY	709.12	02.93 %
4	FACILITY	779.22	03.20 %
5	ROAD	7797.00	32.25 %
<b>TOTAL</b>		<b>24198.00</b>	<b>100.00 %</b>

<b>SCHEME AREA</b>	<b>24198.00 Sq.Yds. 20232.44 Sq.Mtr. 2.0232 Hec.</b>
--------------------	--

योजना का नाम :-  
 PROPOSED LAYOUT PLAN OF SCHEME  
KUNJ VIHAR BORAJ  
 AT REVENUE- VILLAGE- BORAJ & DEOLA,  
 TEH.- MADHORAJPURA, JAIPUR

योजना विकास कर्ता :-

SCALE 1" = 50'

SURVEY CONSULTANT:-



**Bhumichitra**  
 -Bhumichitra Consultancy-  
 Add.- 16, Basement, Bansi Mantion,  
 200ft SEZ Road, Ajmer Road, Jaipur (Raj.)  
 Pin Code :- 302026  
 Mob. :- 9782418282, 8104394446  
 Mail - bhumichitraconsultancy@gmail.com